

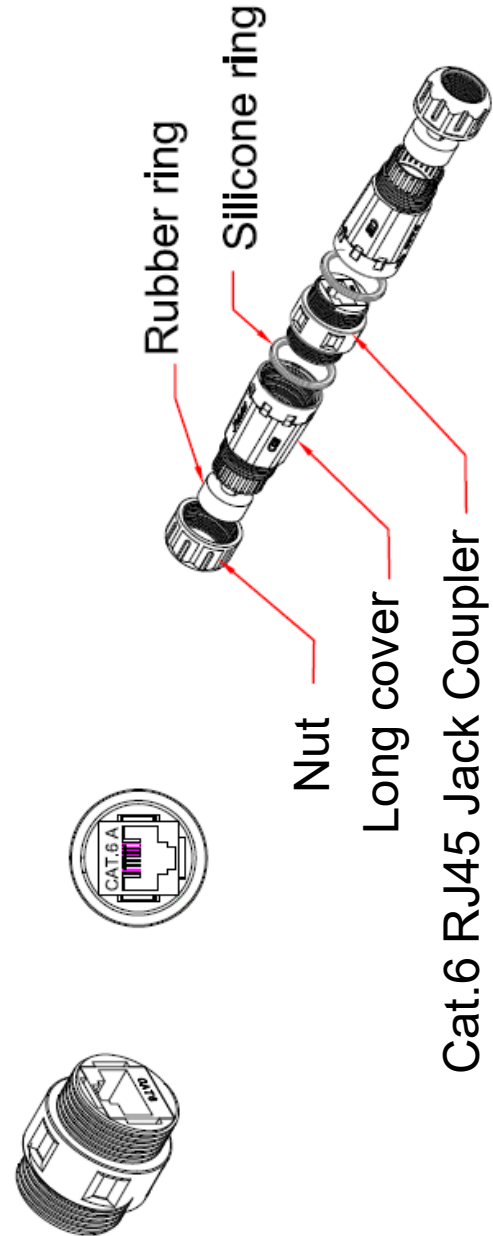

* SUBJECT TO CHANGE WITHOUT NOTICE

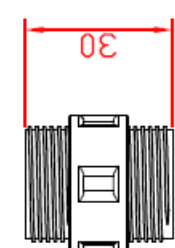
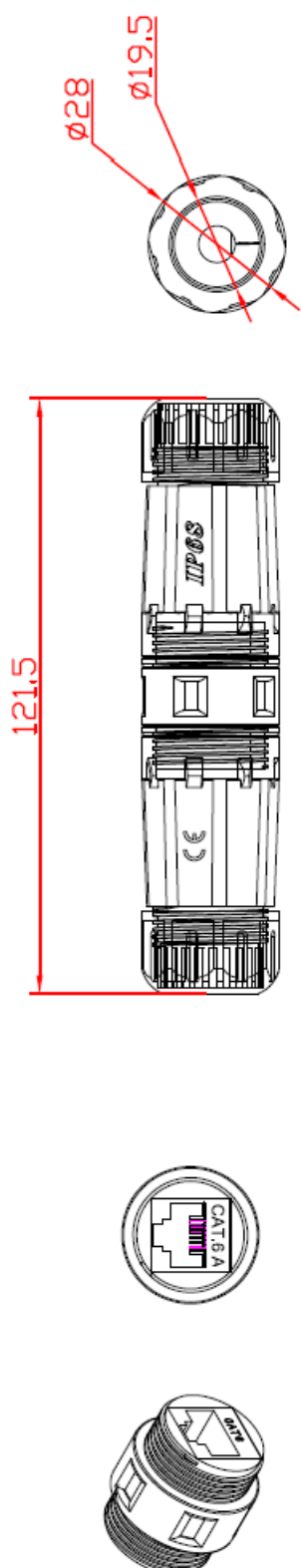

NOTES:

ELECTRICAL:

- 1.VOLTAGE RATING:125 VAC RMS
- 2.CURRENT RATING: 1.5AMP
- 3.CONTACT RESISTANCE:100MILLIOHMS MAX
- 4.INSULATION RESISTANCE:1000 MEGOHMS MIN @500 VDC
- 5.DIELECTRIC STRENGTH:750 VAC RMS 60Hz, 1MIN

ENVIRONMENTAL:

- 1.STORAGE:-40°TO +85°
- 2.OPERATION:-20°TO 70°

MECHANICAL:

- 1.HOUSING MATERIAL: PA66
- 2.INSERT MATERIAL: FAME RETARDANCY PBT
- 3.PCB MATERIAL: FR-4 T=1.6mm
- 4.RJ45 JACK CONTACT: PHOSPHOR BRONZE WITH NICKEL PLATED GOLD PLATED
- 5.RJ45 JACK LIFE:750 TIMES MIN
- 6.Waterproof grade: IP68
- 7.CABLE OD: 5.0 - 7.5mm

REV.	DESCRIPTION	APPROVED BY	DATE	ECN NO.
A	RELEASE	KUNG	2017.05.15	
B				
C				

DRAWN	KU	APP'D	KUNG	UNIT	MM	TOLERANCE	JKL TECHNOLOGY CO., LTD.	TITLE	CAT.6A STP RJ45 OUTDOOR CABLE JOINER , IP68.	SHEET
CHK'D				SCALE	1:1	x ±0.25 .xx ±0.20 .xxx ±0.10 .xxxx ±0.03 ANGULA ±1°	JKL TECHNOLOGY CO., LTD.	PART NO.	RJ45S-C6A-BK	VERSION
								DWG NO.	AP037-S6A	A