

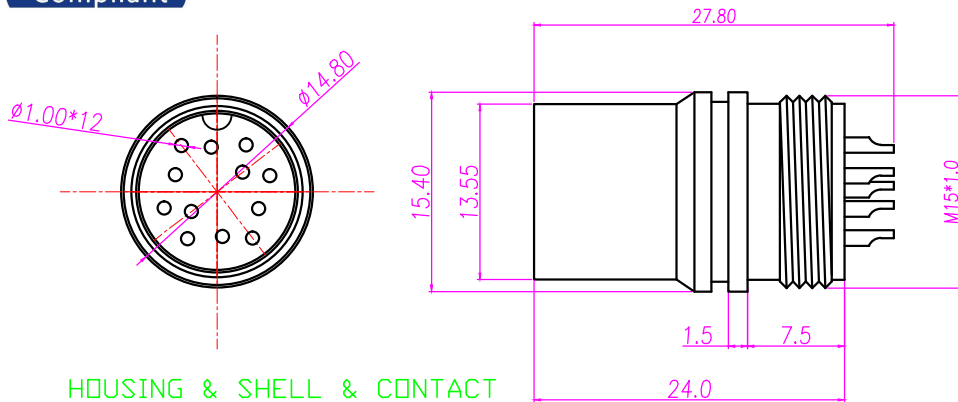

\* SUBJECT TO CHANGE WITHOUT NOTICE

REV.	DESCRIPTION	APPROVED BY	DATE	ECN NO.
A	RELEASE	KUNG	17/03/14*	
B				
C				



HOUSING & SHELL & CONTACT

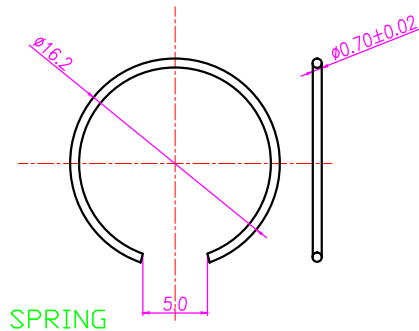

SPRING

- MATERIAL :
  - HOUSING : PA66 ; COLOR : BLACK.
  - CONTACT : BRASS.
  - NUT : BRASS.
  - SHELL : ZINC ALLOY
  - SPRING : Stainless steel .
- FINISH :
  - CONTACT : GOLD FLASH PLATED.
  - NUT : NICKEL PLATED OVER ALL
  - SHELL : NICKEL PLATED OVER ALL
- ELECTRICAL SPECIFICATION :
  - Rated current : 3~8p 10A ; 12P 5A
  - Rated voltage : 125V
  - Water proof : IP67
- Environmental :
  - Operation Temperature : -20℃~85℃

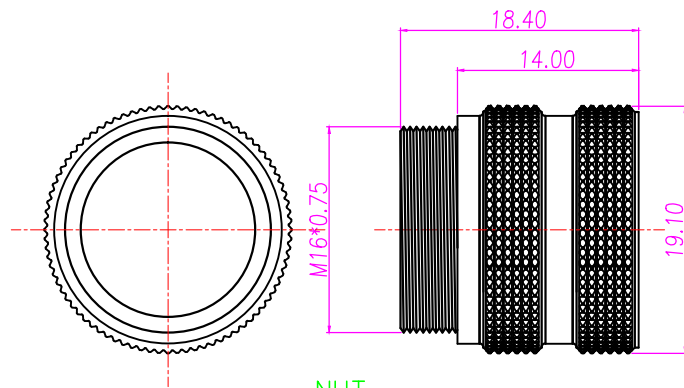

NUT

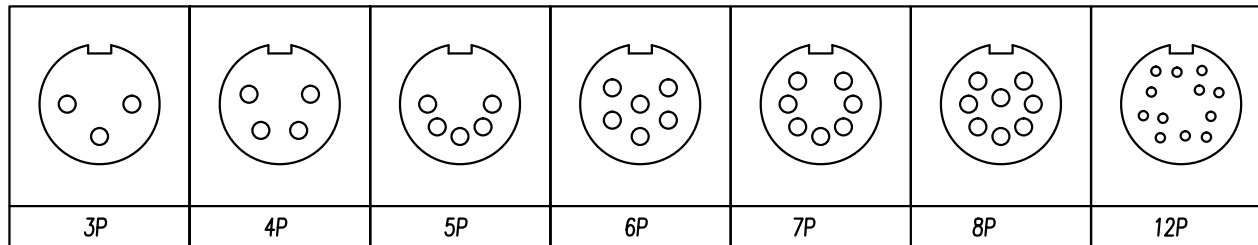

TABLE A

12P	DI-12M2-07-11	GOLD FLASH PLATED
12P	DI-12M2-08-11	SILVER PLATED
8P	DI-08M2-13-11	GOLD FLASH PLATED
8P	DI-08M2-14-11	SILVER PLATED
7P	DI-07M2-05-11	GOLD FLASH PLATED
7P	DI-07M2-06-11	SILVER PLATED
6P	DI-06M2-08-11	GOLD FLASH PLATED
6P	DI-06M2-09-11	SILVER PLATED
5P	DI-05M2-08-11	GOLD FLASH PLATED
5P	DI-05M2-09-11	SILVER PLATED
4P	DI-04M2-15-11	GOLD FLASH PLATED
4P	DI-04M2-16-11	SILVER PLATED
3P	DI-03M2-04-11	GOLD FLASH PLATED
3P	DI-03M2-05-11	SILVER PLATED
PIN	P/N	CONTACT FINISH

DRAWN	KU	APPEND	KUNG	UNIT	mm	TOLERANCE		JKL TECHNOLOGY CO., LTD.	TITLE	M16 12P DIN PLUG WATERPROOF CONNECTOR ,MOLDING TYPE.			SHEET	1
CHOKED				SCALE	1:1	.x ±0.20 .xx ±0.10 .xxx ±0.05 .xxxx ±0.03 ANGULA ±1°			PART NO.	DI-12M2-07-11	DWG NO.	QC7017	VERSION	A